

Program Overview Sunday December 11, 2011



Time	Venue	Activity
7:30-17:00	Foyer	Registration
		Workshops
8:30-12:30*	Port of Hong Kong	International Workshop on Data Mining in Networks (DamNet)
	Port of San Francisco	Handling Concept Drift and Reoccurring Contexts in Adaptive Information Systems. (HaCDAIS)
	Port of New York	Workshop on Learning and Data Mining for Robots (LEMIR)
	Port of Singapore	Workshop on Domain Driven Data Mining (DDDM)
	Hastings	Workshop on Spatial and Spatio-Temporal Data Mining (SSTDM)
	Coal Harbour	Large Scale Visual Analytics (LSVA)
	Pinnacle 1	Workshop on Biological Data Mining and its Applications in Healthcare (BioDM)
	Pinnacle 2	Sentiment Elicitation from Natural Text for Information Retrieval and Extraction (SENTIRE)
	Pinnacle 3	Workshop on Optimization Based Techniques for Emerging Data Mining Problems (OEDM)
	Shaughnessy 1	Workshop on Privacy Aspects of Data Mining (PADM)
	Shaughnessy 2	Workshop on Mining Multiple Information Sources (MMIS)
	Ambleside	Workshop on Data Mining Case Studies (DMCS)
	Dundarave	Declarative Pattern Mining (DPM)
	Point Grey	PhD Forum
14:00-18:00*	Port of Hong Kong	International Workshop on Data Mining in Networks (DamNet)
	Port of San Francisco	Handling Concept Drift and Reoccurring Contexts in Adaptive Information Systems. (HaCDAIS)
	Port of New York	Workshop on Mining Communities and People Recommenders (COMMPER)
	Port of Singapore	Workshop on Domain Driven Data Mining (DDDM)
	Hastings	Workshop on Knowledge Discovery from Climate Data (ClimKD)
	Coal Harbour	Workshop on Knowledge Discovery Using Cloud and Distributed Computing Platforms (KDCloud)
	Pinnacle 1	Workshop on Biological Data Mining and its Applications in Healthcare (BioDM)
	Pinnacle 2	Sentiment Elicitation from Natural Text for Information Retrieval and Extraction (SENTIRE)
	Pinnacle 3	Workshop on Optimization Based Techniques for Emerging Data Mining Problems (OEDM)
	Shaughnessy 1	Workshop on Privacy Aspects of Data Mining (PADM)
	Shaughnessy 2	Workshop on Mining Multiple Information Sources (MMIS)
	Ambleside	Contrast Data Mining and Applications (ContrastDM)
	Dundarave	Data Mining for Service (DMS)
	Point Grey	Data Mining Technologies for Computational Collective Intelligence (DMCCI)

Rooms in Marriott	Rooms in Renaissance
-------------------	----------------------

IBM Research



* break 10:00 to 10:30 & 16:00 to 16:30

Program Overview Monday December 12, 2011

Time	Venue	Activity
7:30-17:00	Foyer	Registration
8:30	Pinnacle Ballroom	Opening
8:40-9:50	Pinnacle Ballroom	Keynote by Dr. Renée J. Miller On Schema Discovery
10:10-12:10	Pinnacle 1	S1A : Graph Mining (5 regular – 2 short)
	Pinnacle 2	S1B : Features (5 regular – 2 short)
	Pinnacle 3	S1C : Frequent Patterns (5 regular – 2 short)
13:30-15:30	Pinnacle 1	S2A : Graphs (5 regular – 2 short)
	Pinnacle 2	S2B : Similarity and Distribution (5 regular – 2 short)
	Pinnacle 3	S2C : Sequences and Patterns (5 regular – 2 short)
15:45-17:45	Pinnacle 1	S3A : Groups, Influences, and Time (4 regular – 3 short)
	Pinnacle 2	S3B : Learning (5 regular – 2 short)
	Pinnacle 3	S3C : Time Series and Sequences (5 regular – 2 short)
		Tutorials
10:10-12:10 13:30-14:30	Point Grey	Sentiment Analysis in Practice Yongzheng (Tiger) Zhang, Dan Shen, Catherine Baudin
14:30-15:30 15:45-17:45	Point Grey	Mining Social Networks for Recommendation Mohsen Jamali, Martin Ester
13:30-15:30 15:45-17:45	Shaughnessy Salon	Exhibits and Demos
18:00-20:00	Harbourside Ballroom	Reception

Program Overview Tuesday December 13, 2011

Time	Venue	Activity
7:30-17:00	Foyer	Registration
8:30-9:45	Pinnacle Ballroom	Keynote by Dr. Lee Giles Data Mining and Information Extraction for CiteSeerX and Friends
10:00-12:00	Pinnacle 1	S4A : Topic Analysis and Text (4 regular – 4 short)
	Pinnacle 2	S4B : Machine Learning and Applications (5 regular – 2 short)
	Pinnacle 3	S4C : Video, Images, and Bioinformatics (4 regular – 4 short)
		Panel
10:00-12:00	Point Grey	Data mining meets exascale and many-core computing
14:00-18:00		Excursion
18:00-21:00	Harbourside Ballroom	Banquet

General Co-Chairs: Osmar R. Zaiane (U. of Alberta) & Wei Wang (U. of North Carolina CH)
Program Co-Chairs: Jian Pei (Simon Fraser U.) & Diane Cook (Washington State U.)
Workshops Co-Chairs: Myra Spiliopoulou (U of Magdeburg) & Haixun Wang (Microsoft Research)
Tutorials Co-Chairs: Evimaria Terzi (Boston U.) & Jure Leskovec (Stanford U.)
Exhibits and Demos Co-Chairs: Ming Hua (Facebook) & Alex Thomo (U. of Victoria)
Local Arrangements Chair: Carson Leung (U. of Manitoba)
Finance Chair & Registration Chair: Charles Ling (U of Western Ontario)

Program Overview Wednesday December 14, 2011

Time	Venue	Activity
7:30-17:00	Foyer	Registration
8:30-9:45	Pinnacle Ballroom	Keynote by Dr. Cynthia Dwork The Promise of Differential Privacy
10:00-12:00	Pinnacle 1	S5A : Intrusion and Anomaly Detection (4 regular – 4 short)
	Pinnacle 2	S5B : Classification (5 regular – 2 short)
	Pinnacle 3	S5C : Patterns and Applications (6 regular)
12:00-13:30	Harbourside Ballroom	Community meeting (with lunch, open to all ICDM participants)
13:30-15:30	Pinnacle 1	S6A : Communities and Privacy (5 regular – 2 short)
	Pinnacle 2	S6B : Clustering (5 regular – 2 short)
	Pinnacle 3	S6C : Reduction, Summarization, & Simplification (5 regular – 2 short)
15:45-17:45	Pinnacle 1	S7A : Recommendation (5 regular – 2 short)
	Pinnacle 2	S7B : Semi-supervised Learning (5 regular – 2 short)
	Pinnacle 3	S7C : Matrix, Tensor, and Sparse Representation (4 regular – 2 short)
		Tutorials
10:10-12:10 13:30-14:30	Point Grey	Mining Sets of Patterns: Next Generation Pattern Mining Bjorn Bringmann, Siegfried Nijssen, Nikolaj Tatti, Jilles Vreeken, Albrecht Zimmermann
14:30-15:30 15:45-17:45	Point Grey	Anomaly Detection: A Tutorial Sanjay Chawla, Varun Chandola

3rd Floor

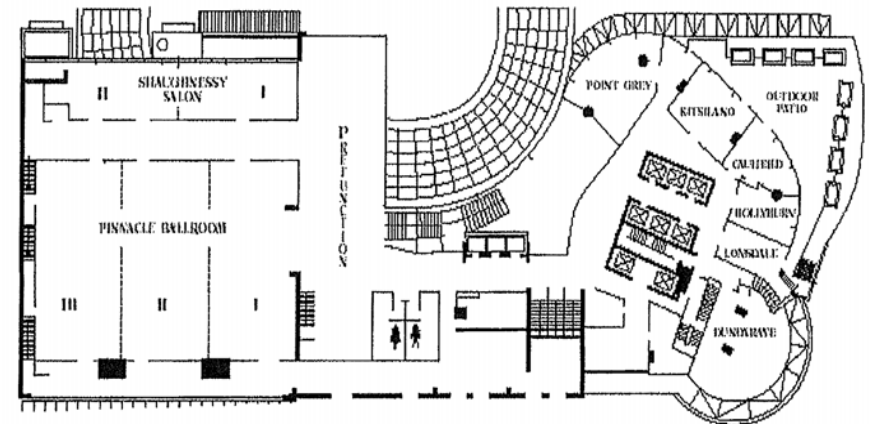

Panel Chair: George Karypis (U. of Minnesota)
Publicity Co-Chairs: Olfa Nasraoui (U. of Louisville), Latifur Khan (U. of Texas at Dallas) & Jie Tang (Tsinghua U.)
Sponsorship Co-Chairs: Wei Ding (U. of Massachusetts Boston) & Gabor Melli (Prediction Works)
PhD Forum Co-Chairs: Rosa Meo (U. of Torino) & Alfredo Cuzzocrea (IHPCN)
Documentation Chair: Gabor Melli (Prediction Works)
ICDM Steering Committee Chair: Xindong Wu (U. of Vermont)